

Real
adventures
on and off
absolutely
any path



The ideal New Zealand motorhome

Explorers are unique motorhomes for New Zealanders. They take the best of every motorhome ever built and discard the rest, leaving you a perfectly-formed kiwi adventure lifestyle machine.

The key to choosing your ideal motorhome really is size. It's easy to build big, but it's another to design a motorhome that does everything you need, yet remains an absolute pleasure to use.

Explorers aren't too big, nor too small. These compact motorhomes are cleverly arranged with everything in a comfortable space that becomes the stage for the most spectacular shows that New Zealand nature can perform for you.

Explorers are as easy to drive and park as a car. And here's the best bit. It's made tough, right here in New Zealand by craftspeople who know more than a thing or two about motorhomes.

That's why we only build the Explorer Compass and Navigator models using one-piece fully moulded fibreglass bodies on the acclaimed Ford Ranger ute. Refined, tough and four-wheel drive to take you to the places other motorhomers can only dream about. Explorer's your best choice when you want to find real adventure wherever the path leads.



GO EVERYWHERE!



NEW ZEALAND'S OWN PRODUCTION 4WD MOTORHOME

Go anywhere, in any season with confidence



RUGGED & DEPENDABLE

One-piece, fully moulded, seamless fibreglass body. Stronger, lighter and no leaks



COMPACT & EASY TO DRIVE

The perfect size to park and manoeuvre. Two Explorer models from only 5.65m to 5.9m in length



FULLY EQUIPPED

Four berths, galley, shower, basin and toilet all fully self-contained for long periods off the grid



BUILT HERE WITH PRIDE

Explorers are built tough for New Zealand conditions. Full service and back up from Explorer Motorhomes

The Explorer compact and complete concept.

Motorhomes built using truck chassis and vans don't always make the easiest vehicles to drive, park or manoeuvre, so Explorer created a new concept. Hop in and go motorhomes as easy to use as a car – but also able to be driven through a stream, up a mountain or across broken ground.

Explorer's first motorhome model was the Compass developed right here in New Zealand in 2007. The slightly larger Navigator model debuted in 2011.

Uniquely, we started by building the new Explorer on brand new ute cab chassis. We designed an efficiently shaped one-piece composite body with smooth rounded edges and an attractive integrated overhead luton to provide better performance,

stability and economy.

The key to the design success has been the overall size and clever use of space to accommodate everything needed for on and off-road touring. Explorers are built tough, waterproof and well insulated for local use. Many motorhomes just don't cut it in our environment.

Since the introduction of the award-winning Ford Ranger ute, which we now use exclusively, Explorer Motorhomes have become even more like cars in comfort, performance, sure-footed safety and easy handling. Superior power and four-wheel drive has revolutionised the capability and appeal of this motorhome for adventurous New Zealanders.



Two intrepid Explorer models take you places the others can't

COMPASS

5.65m L x 2.0m W x 2.9m H

NAVIGATOR

5.9m L x 2.08m W x 2.95m H



Expertly designed and built here in New Zealand

Explorers are designed and manufactured right here by us in Auckland.

ONE-PIECE COMPOSITE BODY

The two different-sized Explorers both have a one-piece composite body using a vacuumed urethane core sandwiched between layers of fibreglass and an outer layer of gelcoat. This produces a durable and hard finish which is easy to maintain and much more resistant to scratches than a painted finish.

LIGHTWEIGHT, STRONG, SEAMLESS & WATERTIGHT

This vacuumed urethane core helps give a seamless, lightweight and strong body with the added benefit of excellent insulation and you know you'll be leak-free.

Using a moulded body is not common in the motorhome industry because producing these moulds isn't easy, but it is the tried and trusted technique in the boating and trucking industries that we know really performs.

QUALITY, QUALITY, QUALITY

Quality is everything to us. We only use industry-leading components that we know will last the distance. We know that your motorhome is going to take you to some pretty exciting places, so everything needs to work and last.

For example, we only use high-pressure laminate on plywood for Explorer's joinery – not MDF-based materials that swell if they are exposed to moisture.

If you're buying a new motorhome, we encourage you to look deeper than the surface.



Explorer Compass

Go-anywhere Compass is New Zealand's most compact complete motorhome. You will be amazed at what Explorer fits into the Compass. Everything you need and more, is on board. All you need is your adventurous spirit.

Look inside Compass and see how Explorer makes the compact footprint of just 5.65 metres long x 2.0 metres wide work so well as a complete motorhome. While Compass is the smaller of the two Explorer models, it offers you 1.95 metres standing height, plenty of space and every convenience to help you make the most memorable days of your life.

The slightly reduced dimensions (25cm shorter and 8cm narrower than Navigator) only impact marginally on overall interior space so, for most, the basic decision revolves around your bed size and how compact you want the overall size of your motorhome.

With the very practical rear dinette and lounge area, you can take in the best views from the large double glazed windows in absolute comfort. There's a great sense of space and light created by the open layout which is complemented by an audio system with stereo speakers.

One of the exclusive features of both Explorers is the low entry to the luton bed above the cab. It takes just one step up to the large airy space with 850mm sitting headroom and a better-than-double permanent bed. Opening windows at each end of the luton bed with built-in insect screens, offer good ventilation. It's a very cosy and comfortable place to be all year round.

If you're accommodating four, pull-out slats convert the rear dinette into another bed for two. This cleverly concealed system is simple and easy to set up and store away.

We only use high quality lightweight plywood joinery with a blonded timber finish for the onboard joinery. There's ample storage in drawers, cupboards, wardrobe and under the side dinette seats. Everything is well positioned and has its rightful place.

Compass has a well-specified galley kitchen with everything you need to prepare great holiday meals. There's a



4-burner gas cooktop and grill. It also features a large 136L (12V/240V) fridge/freezer as standard, so food storage is never a problem. Other features in the galley include the stainless steel sink with folding hot/cold tap and flush-mounting glass lid, lift-up bench extension, a slimline extractor range hood and generous storage to keep everything stored securely when travelling.

The bathroom is fully moulded for easy cleaning and is well ventilated with an opening roof skylight. The toilet is the latest electric flush, bench style Thetford C400 cassette system. There's

also a corner basin with hot/cold single lever tap shower hose on a slide rail.

Compass has fresh water capacity of 80 litres and grey water capacity of 70 litres. Both tanks are fitted with monitors. All Explorer motorhomes are Certified Self Contained.

And finally, the Compass rear boot locker provides particularly spacious storage for everything you want to bring along - BBQ, chairs, tools, wheel chocks, golf clubs, skis or fishing rods.

Explorer Compass really is the whole package. All you need to do is decide where you're off to!

BELOW: One wide, easy step to the permanent double bed.



ABOVE/RIGHT: Explorer's rear dinette lounge area is the perfect position to take in the views and relax. You will be surprised how spacious Compass really is.

BELOW: Take four-wheel drive Explorers virtually anywhere - even through streams up to 800mm deep.



Tow your toys with you.

DAY

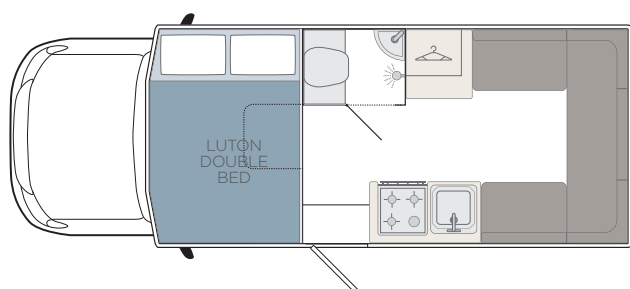

NIGHT

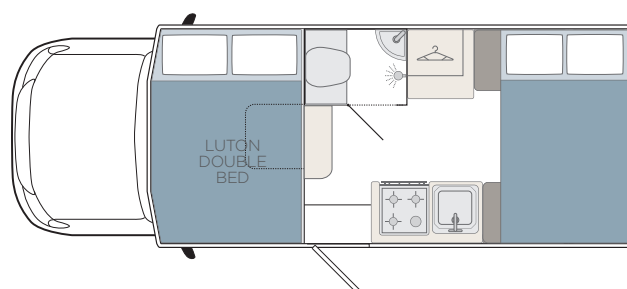

COMPASS FLOORPLAN

Ford Ranger is the best choice for the job

We only build Explorers on Ford Ranger utes, recognised as the best on the market for comfort, features and all-important power.

MORE POWER TO YOU

With 3.2 litres and 147kw of engine power you won't be stuck in queues anywhere in an Explorer even if you want to tow a trailer or boat.

BUILT TO HANDLE THE ROUGH

We completely upgrade the suspension and GVM (gross vehicle mass) to 3500kg, but otherwise, the Ranger is an extremely well specified ute with a stack of safety features for maximum stability and handling wherever you are. And that includes in water up to 800mm deep!



Lithium Edition Electrical System

Explorer's optional electrical system delivers better performance and therefore much greater opportunity and peace-of-mind for you to be off the grid for longer.

Lithium batteries can endure up to ten times more charge cycles than the equivalent-sized lead acid battery, can be fully discharged and be recharged in 3-4 hours.

The heart of the Lithium Edition system is a management unit that operates like six separate products; a DC-to-DC battery charger when the vehicle is on the move, a 240-volt 30-amp mains charger, a 30-amp MPPT solar regulator, a starting battery isolator, a load disconnect controller and a battery monitor.



Explorer Navigator

Navigator offers you even more space for enhanced comfort all round. The permanent queen-sized luton bed is by far one of the biggest, most comfortable and easiest to access of its kind. On road and off, Navigator is perfect.

Navigator's increased dimensions offer more all-round comfort for up to four people while remaining one of New Zealand's most complete, compact motorhomes. At 5.9m long x 2.08m wide Navigator is just as easy to drive and manoeuvre as a large saloon. It's equipped with everything you need and enhanced with a few more options.

We retain the same very practical rear dinette and lounge area of the Compass. The Navigator offers just that bit more space in the dinette seating for lounging about with your favourite book and refreshments. Explorer's rectangular dining table provides a comfortable entertaining area for four. A larger roof skylight allows in plenty of light and ventilation. We also fit an audio system with stereo speakers.

One of the exclusive features of both Explorers is the low entry to the luton bed above the cab. Navigator goes one better here though. This permanent bed is a queen-size measuring 1.5m wide x

2.0m long for those who are a bit taller or like an even more generous relaxing and sleeping space.

It takes just one step up to the large airy space with sitting headroom. Opening windows at each end of the luton bed with built-in insect screens, offer good ventilation. You'll find it hard to find another motorhome with space that matches.

If you're accommodating four, pull-out slats convert the rear dinette into another bed for two which is slightly wider than Compass.

High quality lightweight plywood joinery with a blonded timber finish for the onboard joinery gives Navigator a very stylish and hard wearing finish. There's ample storage in soft-close galley drawers, high cupboards, wardrobe and under the side dinette seats.

Navigator has a very well-specified galley kitchen with a longer bench and pull out pantry. With a gas oven and 3-burner gas hob you have everything



you need to prepare any kind meal even including oven roasts. It also features the large Dometic 136L fridge/freezer (12V/240V) which gives you absolute freedom to be off the grid for long periods. Other features in the galley are the same as in the Compass – stainless steel sink with folding hot/cold tap and flush-mounting glass lid, lift-up bench extension, a slimline extractor range hood and generous storage to keep everything stored securely while travelling.

The bathroom is 100mm longer than in the Compass and features a wider, taller door too. Fully moulded, it's easy to clean and is well ventilated with an opening roof skylight. The Navigator toilet is the latest electric flush, bench

style Thetford C400 cassette system. There's also a corner basin with hot/cold single lever tap shower hose on a slide rail. Navigator adds a mirrored vanity cabinet for additional storage and a useful pull-out drying rack.

Navigator has fresh water capacity of 80 litres and grey water capacity of 70 litres. And the Navigator is Certified Self Contained too.

Navigator's rear boot locker provides just a little more storage than Compass to bring your holiday essentials and leisure toys.

Explorer Navigator is ready for you to head off in any direction, knowing that it just doesn't get any better.



TOP: Navigator's bathroom is larger and easier to access.

ABOVE/LEFT: Great living space and fully equipped galley with gas hobs and oven for real home cooking. Navigator includes pull-out pantry and longer bench.

RIGHT: Navigator's class-leading permanent queen-size luton bed is spacious, comfortable, well-ventilated, and very easy to access.



DAY

NIGHT

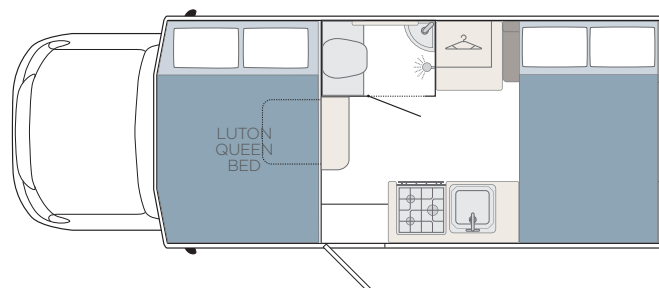
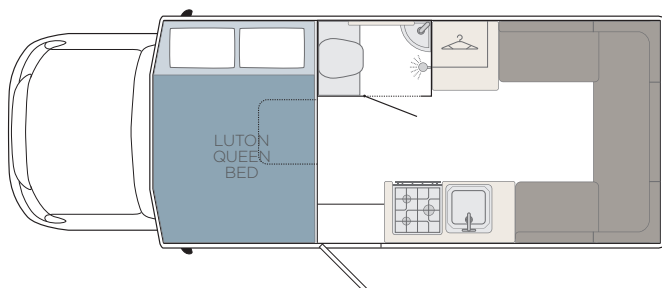

NAVIGATOR FLOORPLAN

Explorer Standard Specifications

Com - Compass / Nav - Navigator

VEHICLE - FORD RANGER	Com	Nav
3.2 litre, 5-cylinder, Diesel	✓	✓
Automatic	✓	✓
4-Wheel Drive	✓	✓
Upgraded suspension system to 3500kg GVM	✓	✓
Airbags: Driver & passenger, front & curtain	✓	✓
ABS Brakes with Dynamic Stability Control	✓	✓
Safety Rating: 5-Star Euro NCAP & ANCAP	✓	✓
Cruise Control	✓	✓
Bluetooth	✓	✓
Remote Central Locking & Engine Immobiliser	✓	✓
Power Windows & Mirrors	✓	✓
Cab Air Conditioning	✓	✓
Clearview extendable & foldable power mirrors		✓
DIMENSIONS (METRES)		
Overall external length	5.65	5.90
External width	2.0	2.08
External height (excluding satellite dish, if fitted)	2.78	2.95
Internal head height	1.95	1.94
TANKAGE (LITRES)		
Fresh water tank (with Tank Monitor)	80	80
Grey water tank (with Hose & Tank Monitor)	70	70
Vehicle Diesel Fuel	80	80
LPG Bottle	5kg	5kg
LIVING		
Rear Dinette Upholstered Seating: Your fabric choice	✓	✓
Removable Dining Table with leg & pole set	✓	✓
Flooring: Vinyl	✓	✓
Lighting: LED ceiling & corner bulkheads	✓	✓
Roof Vent / Skylight: (mm x mm) with integrated blind & insect screen	400	500
Radio / Auxiliary Player Head with stereo speakers	✓	✓
Wardrobe with door(s)	1	2
Storage: Overhead lockers & shelf. Lockers under dinette side seating	✓	✓
Insect screen on entry door		✓
Mirror mounted on outside wall of bathroom	✓	✓
SLEEPING		
Bed (luton) Width (m) x Length (m)	1.35	1.5
	1.95	2.0
Bed (rear) with pull-out slat base: Width (m) x Length (m)	1.15	1.3
	1.95	2.0
Magazine Storage Pocket	✓	✓
LED lighting each side	✓	✓
Privacy curtains x 2: Luton bed & entry to cab	✓	✓
Windows: Double-glazed acrylic with integrated blind & insect screen and telescopic arms, each side	✓	✓
COMPLIANCE		
Certificate of Compliance & Electrical Warrant of Fitness	✓	✓
Certified Self Contained	✓	✓
Warrant of Fitness	✓	✓
Gas Safety Certificate	✓	✓

GALLEY	Com	Nav
Sink: Stainless steel with folding tap & flush-mounting glass lid	✓	✓
Fridge: 136 litre Waeco with freezer (12V/240V)	✓	✓
Stove/Grill: Dometic LPG 4-burner gas cooktop, with flush-mounting glass lid & LPG grill	✓	
Stove/Oven: Spinflo Triplex 3-burner cooktop/oven/grill with flush-mounting glass lid (LPG)		✓
Rangehood: Stainless steel with lights. Ducted (12V)	✓	✓
Benchtops: Formica with solid timber bullnose	✓	
Benchtops: Formica with solid timber bullnose +190mm L		✓
Liftup Bench Extension	✓	✓
Interior Joinery: Manufactured from high pressure laminate on plywood incl. drawers & overhead lockers	✓	✓
Soft-close Joinery Hardware		✓
Pull-out Pantry		✓
Rubbish Bin: Integrated on entry door	✓	✓
BATHROOM		
Larger room dimension +100mm / Taller, wider door		✓
Shower: Moulded acrylic with hot/cold water shower on slide rail	✓	✓
Basin: Corner white acrylic	✓	✓
Toilet: Thetford C400 bench style	✓	✓
Drying Rack		✓
Lighting: LED	✓	✓
Roof Vent / Skylight with insect screen	✓	✓
Storage: Mirrored Vanity Cabinet		✓
ELECTRICAL		
Lighting: LED (12V)	✓	✓
House Battery: 150 amp hour AGM sealed deep cycle	✓	✓
Battery Monitor	✓	✓
Battery Charger: automatic (230V 20 amp)	✓	✓
Caravan Power Lead: 10m	✓	✓
Power Points: 2 x 240V, 2 x 12V	✓	✓
Water Heater: Truma 10 litres (LPG)	✓	✓
SAFETY		
Entry Handrail on upholstered panel	✓	✓
Central Locking on entry door	✓	✓
Gas Detector & Fire Extinguisher	✓	✓
Rear seatbelts & removable headrests for two additional passengers	✓	✓
EXTERIOR		
Moulded Fibreglass Body: Urethane foam core for glossy, seamless exterior & excellent insulation	✓	✓
Windows: Double-glazed acrylic with integrated blind & insect screen & telescopic arms	✓	✓
Rear Boot Locker: Interior light. 1550mm L x 420mm D x 530mm H excluding LPG cylinder locker at left end	✓	
Rear Boot Locker: Interior light. 1620mm L x 420mm D x 530mm H excluding LPG cylinder locker at left end		✓
Retractable Exterior Entrance Step	✓	✓
Running Lights on luton		✓
Exterior LED Entrance Light	✓	✓
Distinctive Fern Graphics	✓	✓

Options & Accessories

Awning
Solar Panels with Regulator
Lithium Battery System
Exterior Electric Entrance Step Upgrade
Reversing Camera
Clearview Power Mirrors: Extendable & foldable (Compass-only upgrade)
LPG or Diesel Heater
19" LCD TV/DVD with wall bracket
Satellite Dish
Alloy Wheels with LT Tyres
Outdoor Shower
Fold Down Outdoor Table
Side Running Boards
Additional Side Locker Door (Compass-only upgrade)
Bike Rack: Standard
Bike Rack: E-Bike
Tow Bar
Additional Fresh Water Tank 50L



Awning



Reversing camera

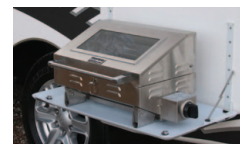

Fold down outdoor table



Clearview extendable and foldable power mirrors are standard on Navigator and an option on Compass



Explorer Motorhomes Limited

Factory: 174 Green Road, Albany RD2, Auckland 0792

Postal: 118 O'Brien Road, Coatesville, Albany RD3, Auckland 0793, New Zealand

info@explorermotorhomes.co.nz

09 447 1442 / 0800 227 144

explorermotorhomes.co.nz

Designs and specifications are subject to change without notice. Errors and omissions excepted.