



**Real adventures
on and off any path**

explorer
motorhomes
GO EVERYWHERE!

The ideal New Zealand motorhome

Explorers are unique motorhomes for New Zealanders. They take the best of every motorhome ever built and discard the rest, leaving you a perfectly-formed kiwi adventure lifestyle machine.

The key to choosing your ideal motorhome really is size. It's easy to build big, but it's another to design a motorhome that does everything you need, yet remains a pleasure to use.

Explorers aren't too big, nor too small. These compact motorhomes are cleverly arranged with everything in a comfortable space that becomes the stage for the most spectacular shows that New Zealand nature can perform for you.

Explorers are as easy to drive and park as a car. And here's the best bit. They're made tough, right here in New Zealand by craftspeople who know more than a thing or two about motorhomes.

We only build the Explorer Navigator motorhome using one-piece fully moulded fibreglass bodies on the acclaimed Ford Ranger ute. Refined, yet tough, the four-wheel drive Ranger will take you to places other motorhomers can only dream about.



GO EVERYWHERE!



NEW ZEALAND'S OWN PRODUCTION 4WD MOTORHOME

Go everywhere,
in any season
with confidence



RUGGED & DEPENDABLE

One-piece, fully
moulded, seamless
fibreglass body.
Stronger, lighter
and leak-free



COMPACT & EASY TO DRIVE

The perfect size
to park and
manoeuvre at
just 6 metres
in length



FULLY EQUIPPED

Four berths, galley,
shower, basin and
toilet all fully
self-contained for
touring off the grid



BUILT HERE WITH PRIDE

Built tough for
New Zealand conditions.
Full service and
back up from
Explorer Motorhomes

Explorer Navigator's compact and complete concept

Motorhomes built using truck chassis and vans don't always make the easiest vehicles to drive, park or manoeuvre, so Explorer created a new concept. Hop in and go motorhomes as easy to use as a car - but also able to be driven through a stream, up a mountain or across broken ground.

We build Explorer Navigators on brand new four-wheel drive ute cab chassis. We add our efficiently shaped, one-piece composite body with smooth rounded edges and an attractive integrated overhead luton for better performance, stability and economy.

The key to the Explorer's design success has

been the overall size and clever use of space to accommodate everything needed for on and off-road touring. Explorers are built tough, waterproof and well insulated for local use. Many motorhomes just don't cut it in our environment.

Since the introduction of the award-winning Ford Ranger ute, which we use exclusively, Explorer Motorhomes are more like cars in comfort, performance, sure-footed safety and easy handling. Superior power and four-wheel drive has revolutionised the capability and appeal of this motorhome for adventurous New Zealanders.

Expertly designed and built here in New Zealand

We've been designing and manufacturing Explorers right here in Auckland since 2007.

ONE-PIECE COMPOSITE BODY

Explorer Navigator has a one-piece composite body using a vacuumed urethane core sandwiched between layers of fibreglass and an outer layer of gelcoat. This produces a durable finish which is easy to maintain and much more resistant to scratches than painted finishes.

LIGHTWEIGHT, STRONG, SEAMLESS & WATERTIGHT

Explorer's body is seamless, lightweight and strong with the added benefit of excellent insulation and you know you'll be leak-free.



Explorer Navigator takes you places the others can't

The perfect motorhome in a very clever package

Navigator offers you all-round comfort and robust build quality from one of New Zealand's best equipped motorhomes within a compact footprint. At just 6 metres long x 2.08 metres wide Navigator is just as easy to drive as a large saloon.

Navigator offers the very practical rear dinette and lounge area with generous space for lounging about with your favourite book and refreshments or sounds from Navigator's stereo system. Explorer's rectangular dining table provides a comfortable entertaining

area for four with a large roof skylight allowing plenty of light and ventilation.

The exclusive feature of Navigator is the low entry to the luton bed above the cab. This permanent bed is a class-leading queen size measuring 1.5m wide x 2.0m long for those who are a bit taller or enjoy a generous relaxing and sleeping space.

It takes just one step up to the large airy space with sitting headroom. Opening windows at each end of the luton bed with built-in insect screens and blinds, offer good ventilation. You'll



find it hard to find another motorhome with space that matches.

If you're accommodating four, there's another pull-out double bed for two in the rear dinette. This cleverly concealed system is simple and easy to set-up and stow away.

High quality lightweight plywood joinery with a blonded timber finish gives Navigator interiors a very stylish and hard wearing finish. There's ample storage in soft-close galley drawers, cupboards, wardrobe and under the side dinette seats.

Navigator has a well-specified galley kitchen with an extra pop-up bench and pull out pantry. With a gas oven and 3-burner gas hob you have everything you need to prepare any kind meal even including oven roasts. It also features a large 130L fridge/freezer (12V/240V) which gives you absolute



DAY

NIGHT

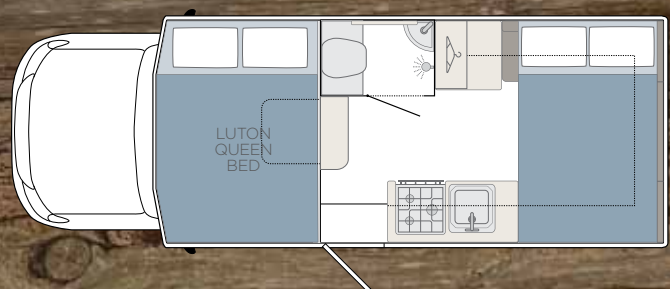
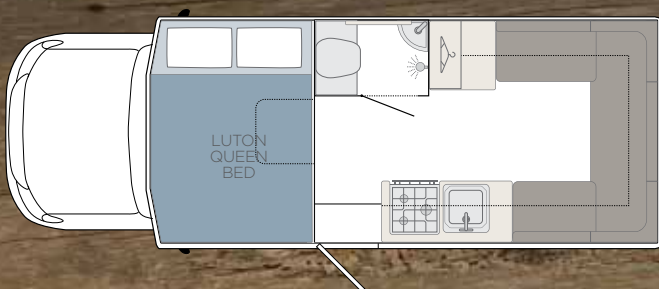

NAVIGATOR FLOORPLAN

Motorhome life doesn't get any better



freedom to be off the grid for extended periods.

Other features in the galley are a stainless steel sink with folding hot/cold tap and flush-mounting glass lid, pop-up bench extension, a slimline extractor range hood and generous storage to keep everything stored securely while you're underway.

The bathroom is easy-to-clean, fully moulded acrylic and is well ventilated with an opening roof skylight. The toilet is the latest electric flush, bench style Thetford C400 cassette system. There's also a corner basin with hot/cold single lever tap and extension shower hose on a slide rail. A mirrored vanity cabinet for additional storage and a useful pull-out drying rack are also included.

Navigator has fresh water capacity of 110 litres and grey water capacity of 70 litres. Both tanks are fitted with monitors. All Explorer Navigator motorhomes are Certified Self Contained.

And outside, the Navigator rear boot locker provides more storage for everything you want to bring along like a BBQ, chairs and tools or your golf clubs, skis or fishing rods.

Explorer Navigator is fully equipped and ready for you to head off in any direction knowing that it just doesn't get any better. Start your adventure today.



TOP: Navigator's class-leading permanent queen-size luton bed is spacious, comfortable, well-ventilated, and very easy to access with one wide step

ABOVE RIGHT: Navigator's fully moulded bathroom

ABOVE LEFT: Entry door with integrated insect screen, blind and rubbish bin



Ford Ranger is the best choice for the job

We only build Explorers on Ford Ranger utes; recognised as the best on the market for comfort, features and all-important power.

MORE POWER TO YOU

With 2 litre Bi-turbo and 154kw of engine power you won't be stuck in queues anywhere in an Explorer even if you want to tow a trailer or boat.

BUILT TO HANDLE THE ROUGH

We completely upgrade the suspension and GVM (gross vehicle mass) to 3500kg, but otherwise, the Ranger is an extremely well specified ute with a stack of safety features for maximum stability and handling wherever you are. And that includes in water up to 500mm deep!

Redarc RedVision & Lithium Battery System

Explorer's optional electrical system delivers better performance and therefore much greater opportunity and off-the-grid peace-of-mind.

Lithium batteries can endure up to ten times more charge cycles than the equivalent-sized lead acid battery; can be fully discharged and recharged in 3-4 hours.

The heart of the Redarc RedVision system is a battery management unit that operates like six separate products; a DC-to-DC battery charger when the vehicle is on the move, a 240-volt 30-amp mains charger, a 30-amp MPPT solar regulator, a starting battery isolator, a load disconnect controller and a battery monitor.

Explorer Navigator Standard Specifications

VEHICLE
Ford Ranger Single Cab XL
2 litre, 4-cylinder, Bi-turbo, Diesel, 154kw
10-Speed Automatic
4-Wheel Drive
Upgraded suspension system to 3500kg GVM
Airbags: Driver & Passenger, front & curtain
ABS Brakes with Dynamic Stability Control
Safety Rating: 5-Star Euro NCAP & ANCAP
Adaptive Cruise Control
Integrated 10.1" Centre LCD Touch Screen
Forward Collision Warning
Lane Keeping Alert
Bluetooth
Remote Central Locking & Engine Immobiliser
Power Windows & Mirrors
Cab Air Conditioning
Clearview extendable & foldable power mirrors
DIMENSIONS
Overall external length 6.0m
External width 2.08m
External height 3.1m (3.3m incl. satellite dish, if fitted)
Internal head height 1.94m
TANKAGE
Fresh water tank (with Tank Monitor) 110 litres
Grey water tank (with Hose & Tank Monitor) 70 litres
Vehicle Diesel Fuel 80 litres
LPG Bottle 5kg
LIVING
Rear Dinette Upholstered Seating: Your fabric choice
Removable Dining Table with stowable leg & pole set
Flooring: Vinyl
Lighting: LED ceiling & corner bulkheads
Roof Vent / Skylight: 500mm x 700mm with integrated blind, insect screen & lights
Radio / Auxiliary Player Head with stereo speakers
Wardrobe with single door
Storage: Overhead lockers & shelf. Lockers under dinette side seating
Insect screen on entry door
Mirror mounted on outside wall of bathroom
SLEEPING
Bed (Luton) Width 1.5m x Length 2.0m with sitting height 820mm
Single, wide step to luton
Magazine Storage Pocket
LED lighting each side
Privacy curtains x 2: Luton bed & entry to cab
Windows: Double-glazed acrylic with integrated blind & insect screen and telescopic arms, each side
Bed (Dinette) with retractable slat base: Width 1.3m x Length 2.0m

GALLEY
Sink: Stainless steel with folding tap & flush-mounting glass lid
Fridge: 130 litre with freezer (12V/240V)
Stove/Oven: Spinflo Triplex 3-burner cooktop/oven/grill with flush-mounting glass lid (LPG)
Ranghood: Stainless steel with lights. Ducted (12V)
Benchtops: Formica with solid timber bullnose plus pop-up extension
Interior Joinery: Manufactured from high pressure laminate on plywood incl. drawers & overhead lockers
Soft-close Joinery Hardware
Pull-out Pantry
Rubbish Bin: Integrated on entry door
BATHROOM
Shower: Moulded acrylic with hot/cold water shower on slide rail
Basin: Corner white acrylic
Toilet: Thetford C400 bench style
Drying Rack
Lighting: LED
Roof Vent / Skylight with insect screen
Storage: Mirrored Vanity Cabinet
ELECTRICAL
Lighting: LED (12V)
House Battery: 150 amp hour AGM sealed deep cycle
Battery Monitor
Battery Charger: Automatic (230V 20 amp)
Caravan Power Lead: 10m
Power Points: 2 x 240V, 2 x 12V
Water Heater: Truma 10 litres (LPG)
SAFETY
Entry Handrail on upholstered panel
Central Locking on entry door
Gas Detector
Fire Extinguisher
Rear seatbelts & removable headrests for two additional passengers
EXTERIOR
Moulded Fibreglass Body: Urethane foam core for glossy, seamless exterior & excellent insulation
Windows: Double-glazed acrylic with integrated blind & insect screen & telescopic arms
Rear Boot Locker: Interior light. 1620mm L x 420mm D x 530mm H excluding LPG cylinder locker at left end
Retractable Exterior Entrance Step
Running Lights on Luton
Exterior LED Entrance Light
Distinctive Fern Graphics
COMPLIANCE
Certificate of Compliance & Electrical Warrant of Fitness
Certified Self Contained
Warrant of Fitness
Gas Safety Certificate
Low Volume Engineered

Options & Accessories

Alloy Wheels
Automatic Satellite Dish
Awning
Bike Rack
Fan - Luton
Fixed Table Leg
Inverter
Heater - Diesel
Outdoor Shower
Outdoor Table - Fold Down
Redarc RedVision & Lithium Battery System
Reversing Camera
Running Boards - Cab
Solar Panels with Regulator - 200W
Step Upgrade - Exterior Electric Entrance
Tow Bar - 2000kg Braked
TV/DVD - 22" LCD with wall bracket



Awning



Reversing camera



Fold down outdoor table



Luton fan



Explorer Motorhomes Limited

174 Green Road
Dairy Flat
Albany RD2
Auckland 0792
New Zealand

info@explorermotorhomes.co.nz

09 415 2266 / 0800 227 144
explorermotorhomes.co.nz

Designs and specifications are subject to change without notice. Errors and omissions excepted.